

Whole House Heat Recovery Unit



Features:

- Highly efficient, low energy solution to condensation and pollutant control
- Continuous ventilation in kitchen and 6 additional wet rooms
- Up to 93% heat recovery efficiency
- Very low noise levels
- Building Regulations Part L and Part F compliant



General

- **SAP Q eligible** whole house heat recovery unit for homes
- Continuous ventilation
- Maximum airflow 280 m³/hr
- Suitable for areas up to 150 m²
- Up to 93% of heat is recovered from air extracted from warm, moist rooms replacing it with fresh, filtered, warmed air to create a stable, comfortable, healthy environment
- For fitting vertically into lofts, false ceilings or cupboards
- Easy to install – Wall fixing bracket supplied (can be fitted to floor with use of support feet—not supplied)
- Multiple choice low (trickle) speed and boost options set at installation
- Boost speed obtainable by user
- Complete with thermostat for automatic switching off intake fan when external temperature very low
- Low noise levels
- Low running costs
- Gives extra security by removing need to open windows
- 3 year warranty
- Vectaire Ltd can supply all accessories for use with these units, including ducting and metal filters, outside grilles and wall cowls

Specification

- Compact unit
- Casing in galvanised sheet steel with epoxy finish
- Thermo-acoustic lining in polypropylene
- Removable G4 filters
- Low energy DC brushless motor for optimum combination of high performance, low noise levels and low energy consumption
- Impellers are single width, single inlet, direct drive and forward curved for higher efficiency
- 95% Efficient counter flow heat exchanger

Complies with

- Part L of Building Regulations for enhanced energy saving capability
- Part F of Building Regulations for reliable, efficient ventilation
- Conforms to requirements of EC Council directives relating to Electromagnetic Compatibility and Electrical Safety: 2007/95/CE (LVD), 2004/108/CE (EMC), EN 60335-2-80
- CE Marked
- **SAP Q eligible**
- **EST Best Practice Performance Compliant**

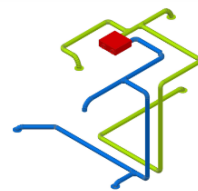
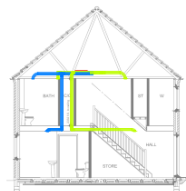
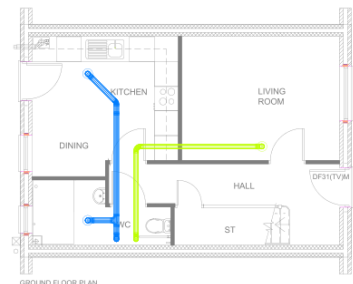
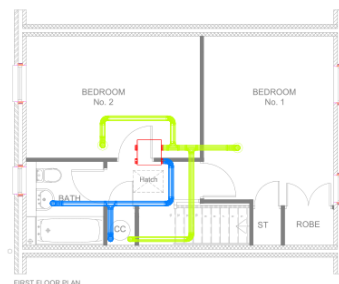

Free design service

AERA – Technical Information

Energy Level Performance—using rigid ducting

Exhaust Terminal Configuration	Fan Speed Setting	Specific Fan Power (W / l /s)	Heat Exchange Efficiency (%)	EST Best Practice Performance Compliant
Kitchen + 1 additional wet room	100% Variable	0.71	93	Yes
Kitchen + 2 additional wet rooms	100% Variable	0.64	93	Yes
Kitchen + 3 additional wet rooms	100% Variable	0.69	92	Yes
Kitchen + 4 additional wet rooms	100% Variable	0.77	91	Yes
Kitchen + 5 additional wet rooms	100% Variable	0.89	90	Yes
Kitchen + 6 additional wet rooms	100% Variable	0.98	90	Yes

BRE test results at minimum flow rate conditions

Performance

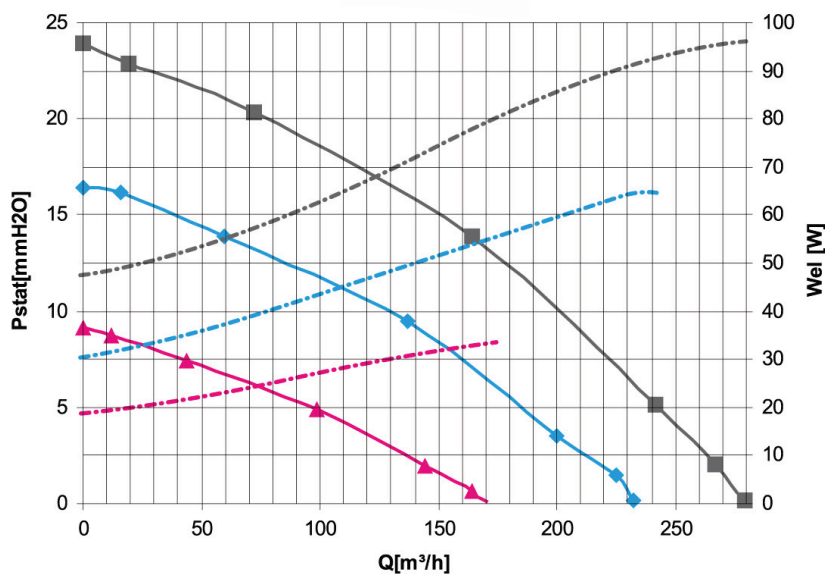

The curves refer to the following indicative regulation values:

PERFORMANCE CURVES	
Curve	Set up
—■—	100 %
—◆—	80 %
—▲—	60 %

POWER ABSORPTION CURVES	
Curve	Set up
---	100 %
-.-.-	80 %
· · ·	60 %

Dimensions – mm

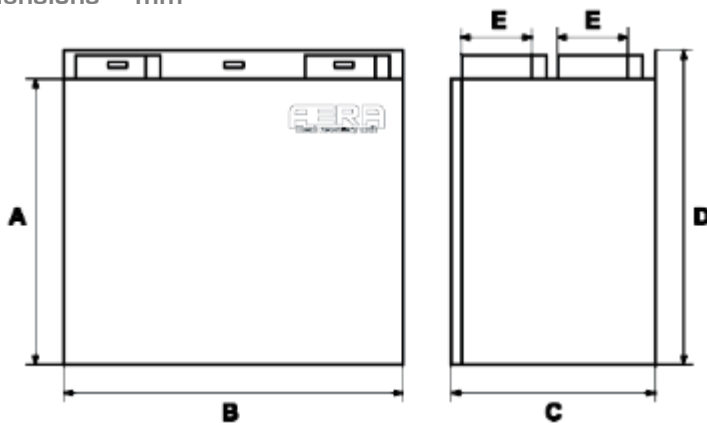

A	507
B	602
C	385
D	557
Ø E	125

Weight 25 kg

Darren Jones

Area Sales Manager

Tel/Fax: 02920 888032

Mobile: 07977 485363

Email: darren.jones@vectaire.co.uk

Vectaire Ltd

Lincoln Road
Cressex Business Park
High Wycombe
Buckinghamshire

Tel: 01494 522333

Fax: 01494 522337

Web: www.vectaire.co.uk

